



ARDEX SPECIFICATION

RETAIL





## ARDEX GROUP

For more than 70 years, ARDEX has been the quality leader for an entire industry, offering excellent building chemicals with supreme processing reliability – the brand of choice for installers and wholesalers.

Strong internal growth and intelligent acquisitions in foreign markets today puts the ARDEX Group on the map with 53 subsidiaries and 3000 employees in over 100 countries on all continents, with one unique theme around the world; ARDEX ensures our valued customers receive the same high quality products and services.

ARDEX Australia is part of the ARDEX Group, a company founded in Germany in 1949, that has grown to become a global business, providing engineered solutions for tiling, flooring, waterproofing and concrete repair.

From sub-floor to roofing, we have developed products that stand the test of time – and moisture. Non-failure in these areas, even under extreme conditions, is critical which is why so many professionals rely on ARDEX.

Innovation has been a key influencer to this continued success, with technologies introduced many years ago still unique in their respective industries today. Being part of the Global ARDEX Group, ARDEX Australia has access to a huge research and development resource which is continually developing world unique products and technologies.



### SYSTEM ARDEX

ARDEX is committed to developing products that are easy to use and offer high performance. ARDEX products, systems and services are designed to ensure professional contractors get the competitive advantage of a lower total cost of installation through superior performance.

ARDEX tiling and waterproofing products are designed to work together for total reliability and performance. Each product is the careful result of research and development combining the input of contractors, specifiers and installers to ensure absolute product compatibility.

A system of high quality, totally compatible products matched to unparalleled technical and field support.

We call this SystemARDEX.

## SUSTAINABILITY



Source raw materials, packaging and products responsibly and work with our suppliers to deliver materials within our sustainability platform objectives.



Consider the life-cycle of products from innovation to disposal, and apply product declarations to support their use in the marketplace.



Promote the use of our products in repair and restoration to prevent the generation of waste from substrate/core structure replacement.



Use energy efficiently throughout our business processes. Measure and commit to reducing energy consumption and source its supply in line with the sustainability vision.



Eliminate waste and reuse, recycle or recover energy from waste that cannot be otherwise prevented. Waste will only be land-filled as a last resort.



Develop sustainable workplace environments, foster employee awareness to act in accordance to these values and promote social responsibility.





# ARDEX PRODUCT CATEGORIES

ARDEX offers a complete product offering, enabling customers to choose the right product based on their specific needs.

From entry level products and workhorses through to benchmark premium products, solutions for all price and performance requirements are available.

## TILING

Tile Adhesives  
Natural Stone Adhesives  
Ready Mixed Adhesives  
Flexible Adhesives  
Rapid Technology  
Rapid Setting Adhesives  
Decoupling Systems  
Crack Isolation Systems

## FLOORING

Self-Levelling Compounds  
Bulkfill Compound  
Wear Surfaces  
External Levelling  
Engineered Screeds  
Vinyl Adhesives  
Repair Mortars  
Patching Mortars

## WATERPROOFING

Liquid Applied Membranes  
WeldTec Sheet Membrane

- Undertile
- Exposed
- Green Roofs & Planter Boxes
- Belowgrade and Tanking

Potective Facade Coatings  
Trafficable Membranes & Coatings  
Butynol Membranes  
Torch-applied Membranes

## GROUTS & SILICONES

Epoxy Grouts  
Commercial Grouts  
Cement Based Grouts  
Silicone Sealants

## GENERAL CONSTRUCTION

Concrete Repair Mortars  
Renders  
Construction Grouts  
Rapid Setting Repair Mortars  
Structural Crack Repair  
Construction Sealants





# SOLUTIONS FROM BASEMENTS TO ROOFTOPS

EXPOSED ROOFTOP WATERPROOFING SYSTEMS

GREEN ROOF & PLANTER BOX WATERPROOFING SYSTEMS

EXTERNAL WATERPROOFING SYSTEMS FOR BALCONIES AND TERRACES

RENDERS AND PATCHING COMPOUNDS

FACADE COATINGS

EXTERNAL SCREEDS & FLOOR LEVELLING SYSTEMS

GROUTS AND SILICONES

BELOW GRADE WATERPROOFING SYSTEMS FOR BASEMENTS AND LIFT PITS

EXTERNAL TILING SYSTEMS

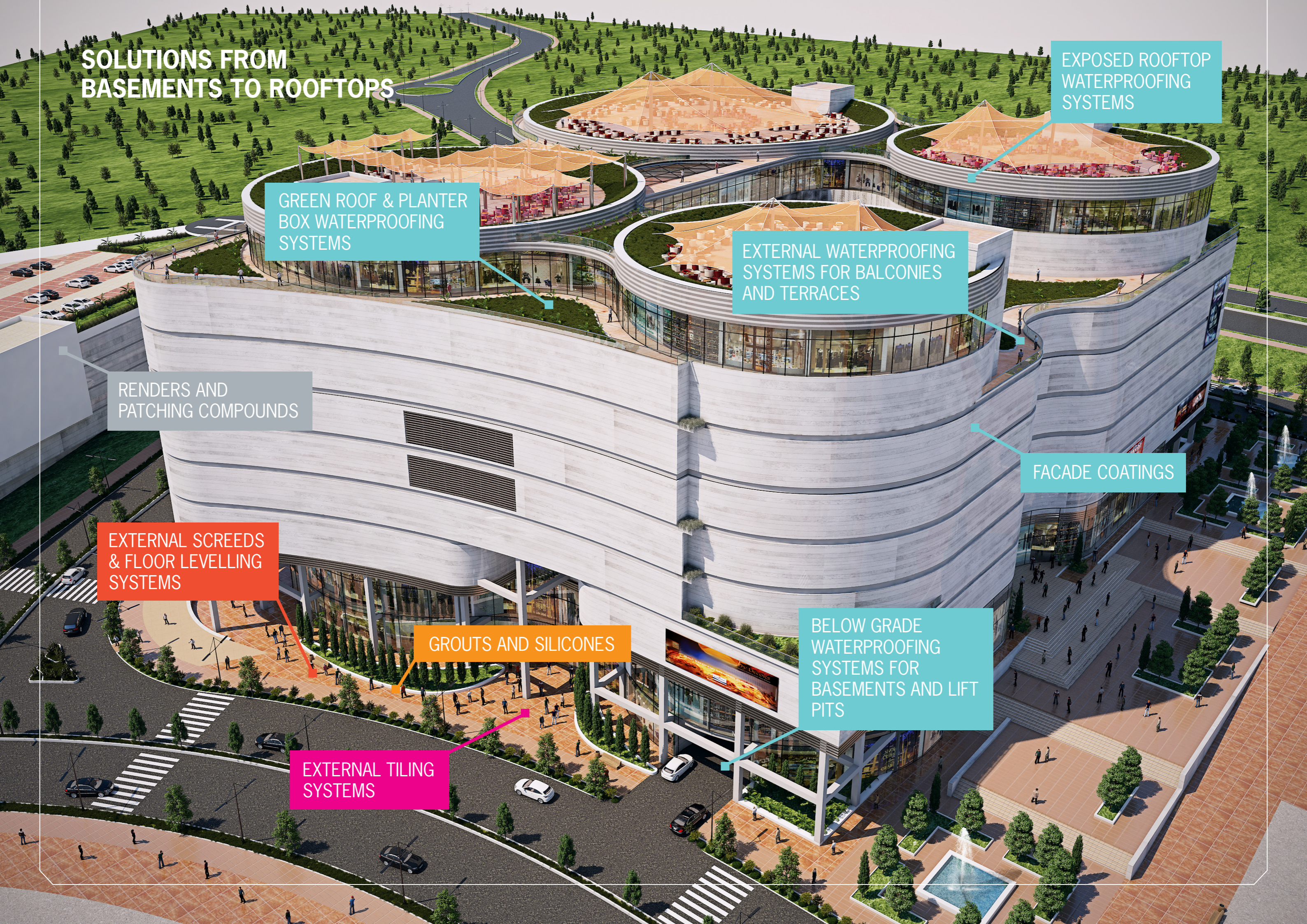



# SOLUTIONS FROM RETAIL STORES TO WASHROOMS

DECOUPLING  
SYSTEMS

GROUTS AND SILICONES

TILE ADHESIVES

FLOWABLE EPOXY  
GROUTS

FLOOR LEVELLING  
SYSTEMS

SANITARY SILICONES

TILE ADHESIVES

CEMENT BASED &  
EPOXY GROUTS

SCREED AND  
LEVELLING SYSTEMS

UNDERTILE  
WATERPROOFING  
SYSTEMS



## PROJECT SOLUTIONS

THE EMPORIUM,  
MELBOURNE, VIC

# 21,000m<sup>2</sup>

of ARDEX A38, ARDEX WA100, and ARDEX rapid setting tile adhesives installed.

RETAIL



An ARDEX specification was chosen as it provided a solution that could help contractors meet the tight deadline as well adhesives that could fix the heavier tiles specified for the internal lobby areas. For the larger tiles ARDEX X 18 tile adhesive was used as it contains specially developed fibres that add strength to the tiled area and is non-slump, making this ideal for heavy tiles on both floors and walls. As the internal wet areas required a fast turnaround, ARDEX specified ARDEX WPM 155 Rapid water-based waterproofing membrane in conjunction with ARDEX STB Tape for rapid installation

WESTFIELD MIRANDA,  
MIRANDA NSW

# 12,000m<sup>2</sup>

of ARDEX A38 and ARDEX rapid setting tile adhesives installed.

RETAIL



The main criteria for this project when looking at the different options were speed of curing for the screed and tiling adhesive as work had to be completed at night & the centre to be ready in the morning for minimal disruption to walkways. Having the ability to accept heavy foot traffic within 8 hours of installation, the A38 screed system ensured strict timeframes were met during the installation of this critical part of the system. The following night the areas containing the A38 screed were prepared for the ARDEX Rapid Hardening and Rapid Drying Tile and Natural Stone Adhesive to install the Terrazzo tiles and natural stone.

MERCEDES BENZ  
AUTOHAUS,  
NEWSTEAD, QLD

# 15,000m<sup>2</sup>

of ARDEX K15 and ARDEX X18 installed.

RETAIL



HARBOUR TOWN EATS,  
GOLD COAST, QLD

# 5,000m<sup>2</sup>

of ARDEX UI740 and ARDEX Quickbond installed.

RETAIL



A specific ARDEX system was recommended to ensure a consistent and high-quality look. This system included **ARDEX Flexbone UI 740** which is a high load-bearing, bonded, uncoupling membrane which is ideal for use with tiles and stone in high traffic areas. The system helps neutralise underlying substrate movement and supports and distributes heavy loads from above. It also helps prevent grout joint and tile damage from movement and deflection. **ARDEX Quickbond** and **ARDEX E 90** admix was the adhesive used which provided a quick-dry solution so no retail outlet was affected and could continue trade as normal.



## SPECIFICATION & TRAINING

### SPECIFICATION

Construction practices are diverse throughout Australia and each project is unique, requiring different products based on location, environment and application.

ARDEX manufactures a unique and diverse portfolio of specialty building products to meet the needs of local markets. Architects, designers and engineers who are working on a project can contact an ARDEX Specification Representative to assist them in selecting the appropriate ARDEX product based on the location of their project and create specifications.



Our industry, like any other, requires on-going training to keep up with the changes in legislation/standards and materials (tiles, concrete, substrates etc). ARDEX offers training for both the applicator as well as design practitioners.

For members of the construction industry committed to providing a high level of workmanship, ARDEX can help stay up to date, and increase both knowledge and confidence when specifying.

### CPD TRAINING

As a member of the Refuel CPD Provider Network ARDEX Australia are proud to offer online formal CPD training to you. Our courses are aimed to educate and aid architects, specifiers and designers on the topics of waterproofing, tiling and flooring systems.

These one hour sessions can be facilitated online or face to face and offer 1 formal CPD point for each topic.

The topics we have are;

- The 4 Key Components of Successful Waterproofing
- Sources of Moisture and Damp Slab Problems
- Floor Preparation For Resilient and Textile Floor Finishes
- Efflorescence & Sources of Grout Discolouration
- Understanding Grout

To view and register for any of our upcoming online sessions please visit <https://ardexaustralia.com/services/event-directory/ardex-cpd-training/>

## WARRANTY

### ARDEX WARRANTIES

The major point of difference between an ARDEX warranty and other warranties is the extent of the cover provided for the owner or builder.

Most competitor product warranties only cover the replacement of the defective product in the case of a claim. This cover is further reduced by a discounting structure based on the years of service prior to the claim. No cover is provided for the costs incurred in removing the defective product, re-installing the replacement product and the re-instatement of any coverings that existed over the top of the product. These costs can involve the owner or builder in a far greater expenditure than the discounted replacement cost of the defective product.

### ARDEX PRODUCT & SYSTEM ARDEX WARRANTIES

ArDEX warranty claims cover:

- a) the costs of repair to which the product is applied and damaged by removal of the defective product where such proves necessary.
- b) the cost of reinstatement or repair of the Product or System including material costs of equal or equivalent products.
- c) the costs of rectification of any material covering the product and removed to repair the product such as tiles, vinyl, etc. (Note: Replacement of floorcoverings limited to period of manufacturers warranty). ArDEX warranty claims are NOT discounted by years of service of defective products of any damage to the surface or material.

## TECHNICAL SUPPORT

### TECHNICAL SUPPORT

ARDEX products are backed by a team of Technical Support Specialists and Sales Professionals dedicated to one goal – eliminating guesswork, improving onsite efficiencies and taking risk out of installations. ARDEX supports building professionals to complete successful projects by having:

- The largest field team of trained professionals
- Project specific installation recommendations
- Job start-up and walk-through support
- Trained contractor recommendation
- Extensive digital resources

### CONTACT

Contact our Technical Services Department for help with anything out of the ordinary, If we don't already have the answer we will certainly investigate.

Technical Services Toll Free  
**1800 224 070 (Australia)**

Technical Data is available on the ARDEX Australia Website [www.ardexaustralia.com](http://www.ardexaustralia.com) and the **ARDEX Australia Mobile App**.





■ **ARDEX AUSTRALIA PTY LTD**

7/20 Powers Road  
Seven Hills NSW 2147

1300 788 780

[technicalservices@ardexaustralia.com](mailto:technicalservices@ardexaustralia.com)

[www.ardexaustralia.com](http://www.ardexaustralia.com)

■ **TOLL FREE TECHNICAL SERVICES**

1800 224 070 (Australia)

