

**TYPICAL PERIMETER
DETAIL - ARDEX UD 150**

NOTES

Bond breaker / fillets will be required for all ARDEX Liquid Applied Membranes. Please refer to product data sheet for more information.

ARDEX MEMBRANE includes:

- ARDEX WPM 002
- ARDEX WPM 909
- ARDEX WPM 157
- ARDEX WPM 8' Series
- ARDEX WPM 155 Rapid Plus
- ARDEX WELDTEC™ MEMBRANE
- ARDEX WPM 130 Builders Express

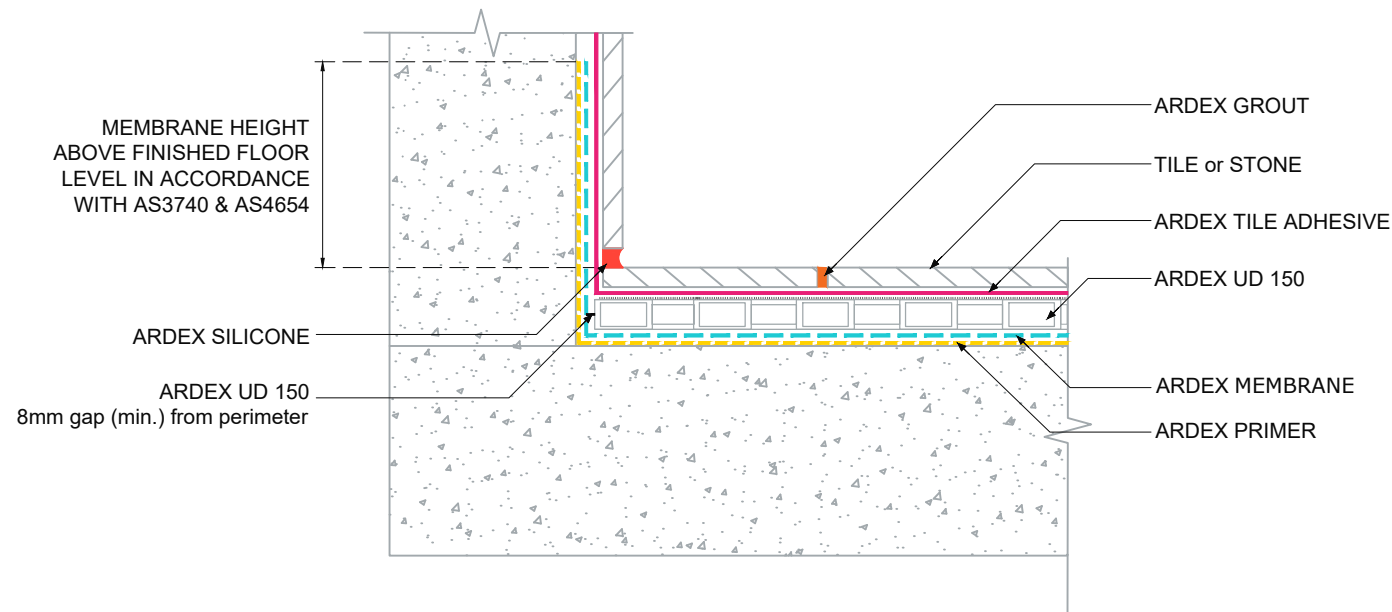

The technical details, recommendations & other information contained in this drawing is given in good faith & represents the best of our knowledge and experience at the time of design. It is your responsibility to ensure that our products are used used correctly in accordance with any applicable Australian Standard, our instructions & recommendations are only for the uses they are intended. We also reserve the right to update information without prior notice to reflect our ongoing research and development program. Country specific recommendations, depending on local standards, codes of practice, building regulations and industry guidelines may effect specific installation recommendations. The supply of our products and services are also subject to certain terms, warranties & exclusions which are available to you on request

FILE NAME	TYPICAL PERIMETER DETAIL - ARDEX UD 150
DRAWN	22/10/2024 by AD
CHECKED	ADAM MCGLONE
SIZE	A4

ARDEX AUSTRALIA
www.ardexaustralia.com

SCALE NTS
DRAWING D163