

**TYPICAL MOVEMENT
JOINT DETAIL - ARDEX UD
150**

NOTES

Joint detailing for the ARDEX MEMBRANE will differ depending on specific membrane being applied and potential joint movement (to be determined by project consultant).

The type of ARDEX SEALANT to be used will differ depending on specific membrane being applied and potential joint movement (to be determined by project consultant).

The use of duct tape is to prevent entry of tile adhesive into the joint.

After the ARDEX Waterproofing Membrane has been applied and the floor movement joints detailed accordingly, cut the ARDEX UD 150 mat where necessary and provide a 5mm minimum gap between sheets over the joint (excluding construction joints). The exact joint width of a construction joint must be honoured through the ARDEX UD 150 mat and finished tiled surface.

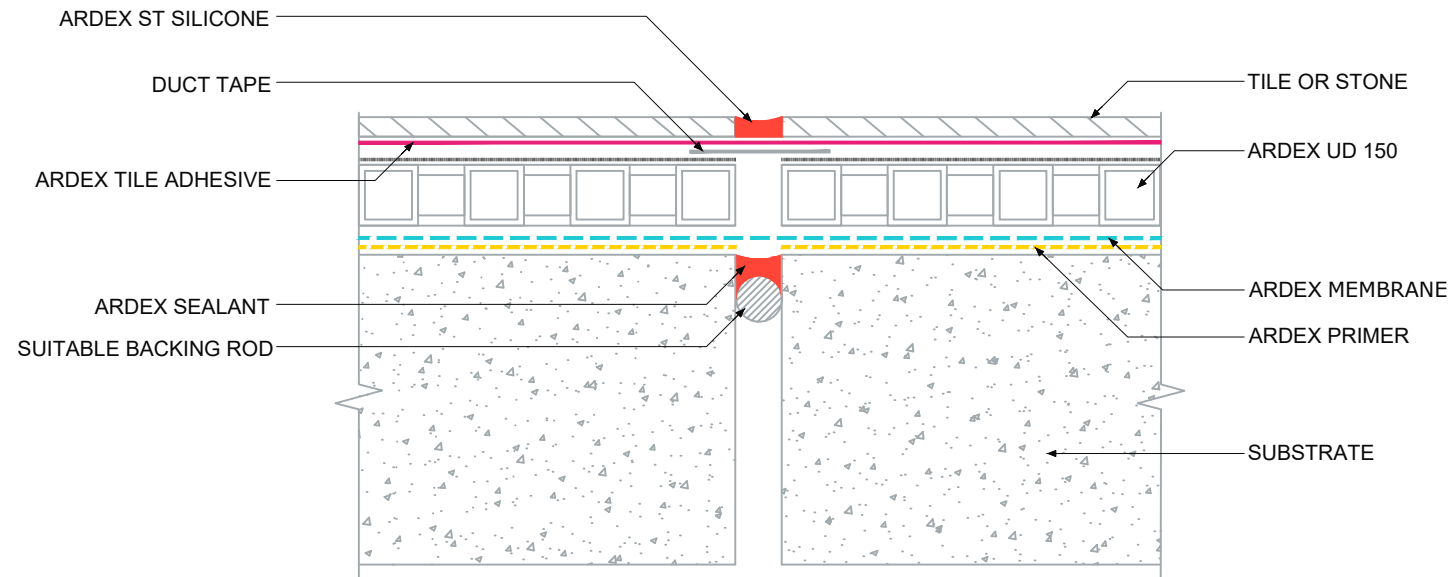

ARDEX AUSTRALIA
www.ardexaustralia.com

The technical details, recommendations & other information contained in this drawing is given in good faith & represents the best of our knowledge and experience at the time of design. It is your responsibility to ensure that our products are used used correctly in accordance with any applicable Australian Standard, our instructions & recommendations are only for the uses they are intended. We also reserve the right to update information without prior notice to reflect our ongoing research and development program. Country specific recommendations, depending on local standards, codes of practice, building regulations and industry guidelines may effect specific installation recommendations. The supply of our products and services are also subject to certain terms, warranties & exclusions which are available to you on request

FILE NAME	TYPICAL MOVEMENT JOINT DETAIL - ARDEX UD 150
DRAWN	22/10/2024 by AD
CHECKED	ADAM MCGLONE
SIZE	A4

SCALE	NTS
DRAWING	D162