

**VERTICAL DOWNTURN WITH
REGLET TERMINATION -
ARDEX WPM 715**

NOTES

ARDEX WPM 715 must be solvent wiped (allow to flash off) then apply ARDEX WPM 299 SEAM PRIMER (allow to dry) prior to ARDEX RA 88 PLUS application directly onto ARDEX WPM 715

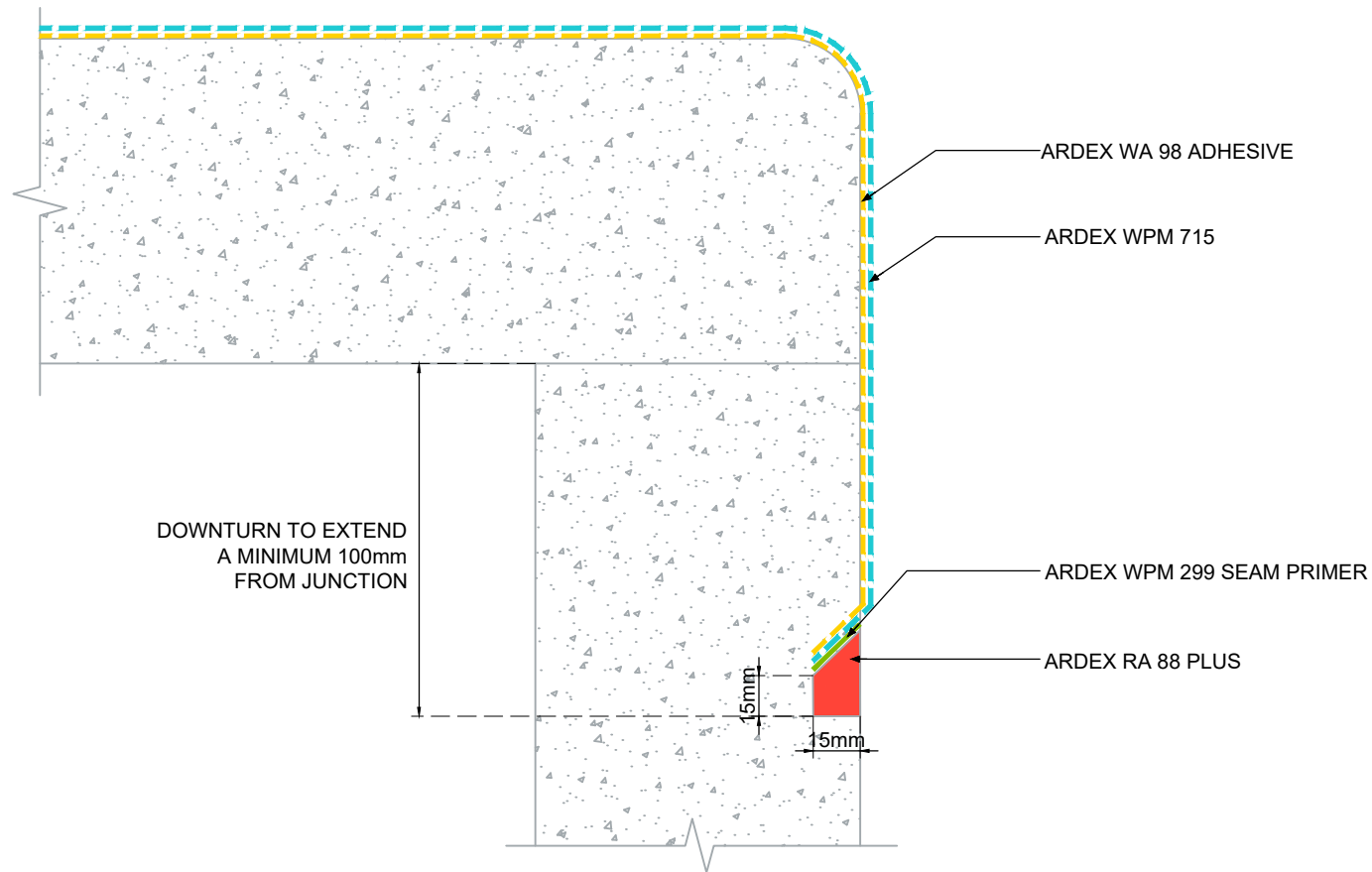

DOWNTURN TO EXTEND
A MINIMUM 100mm
FROM JUNCTION

ARDEX WA 98 ADHESIVE

ARDEX WPM 715

ARDEX WPM 299 SEAM PRIMER

ARDEX RA 88 PLUS



ARDEX AUSTRALIA
www.ardexaustralia.com

The technical details, recommendations & other information contained in this drawing is given in good faith & represents the best of our knowledge and experience at the time of design. It is your responsibility to ensure that our products are used correctly in accordance with any applicable Australian Standard, our instructions & recommendations are only for the uses they are intended. We also reserve the right to update information without prior notice to reflect our ongoing research and development program. Country specific recommendations, depending on local standards, codes of practice, building regulations and industry guidelines may effect specific installation recommendations. The supply of our products and services are also subject to certain terms, warranties & exclusions which are available to you on request

FILE NAME VERTICAL DOWNTURN WITH REGLET
TERMINATION - ARDEX WPM 715

DRAWN 27/08/2024 by AD

CHECKED ADAM MCGLONE

SIZE A4

SCALE NTS

DRAWING D145